



SEALING PLUGS

SERIES LK 600

KOENIG-EXPANDER®

Material

Sleeve: Stainless Steel, Special oil film lubrication
 Mandrel: Stainless Steel, Special oil film lubrication

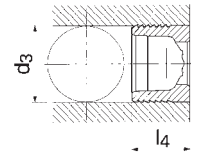
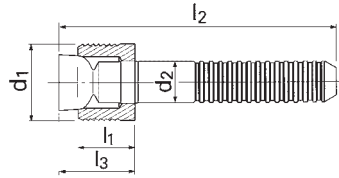

Important: See installation instruction on page 99
Installation requirements on pages 100–106

3D-DATEN: <http://kvt.partcommunity.com>

Part Number	d ₁	l ₁	d ₂	l ₂	d ₃ +0.12 0	l ₃ max.	l ₄ max.	Packaging Unit	
LK 600-040	4,0	3,7	2,2	33	4,0	6,05	4,0	100	1000
LK 600-050	5,0	4,5	2,5	36	5,0	7,40	4,8	100	1000
LK 600-060	6,0	5,0	3,2	36	6,0	8,20	5,5	100	1000
LK 600-070	7,0	5,5	3,8	32	7,0	9,05	5,8	100	500
LK 600-080	8,0	6,5	4,3	34	8,0	10,75	7,0	100	500
LK 600-100	10,0	7,0	4,9	34	10,0	11,25	7,5	100	500

Dimensions in millimeters

PRESSURE PERFORMANCE

Series LK 600 mm	Base material of the Installation						
	①	②	③	④	⑤	⑥	⑦
	ETG-100 / 44SMn28 AISI 1144	C15Pb 1.0403	EN-GJL-250 EN 1561	EN-GJS-500-7 EN 1563	AlCu4Mg1 EN AW-2024-T3	AiMgSiPb EN AW-6012-T6	G-AiSi7Mg EN AC-42100
Ø 4 – 10	180 bar / 2.600 psi 60 bar / 850 psi						

Proof Pressure Test ☺

Max. allowable Working Pressure = Nominal Pressure